

ATTACHMENT #6

MINNEHAHA COUNTY  
UNNAMED FEATURE

DOCUMENTATION

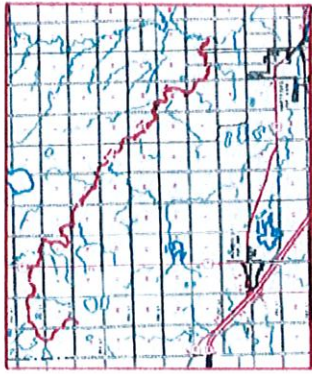

GENERAL HIGHWAY MAP  
**MINNEHAHA COUNTY**  
SOUTH DAKOTA

Prepared by the  
SOUTH DAKOTA DEPARTMENT OF TRANSPORTATION  
U.S. DEPARTMENT OF TRANSPORTATION  
FEDERAL HIGHWAY ADMINISTRATION

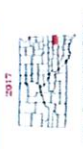

2017

STATE OF SOUTH DAKOTA

MINNEHAHA COUNTY

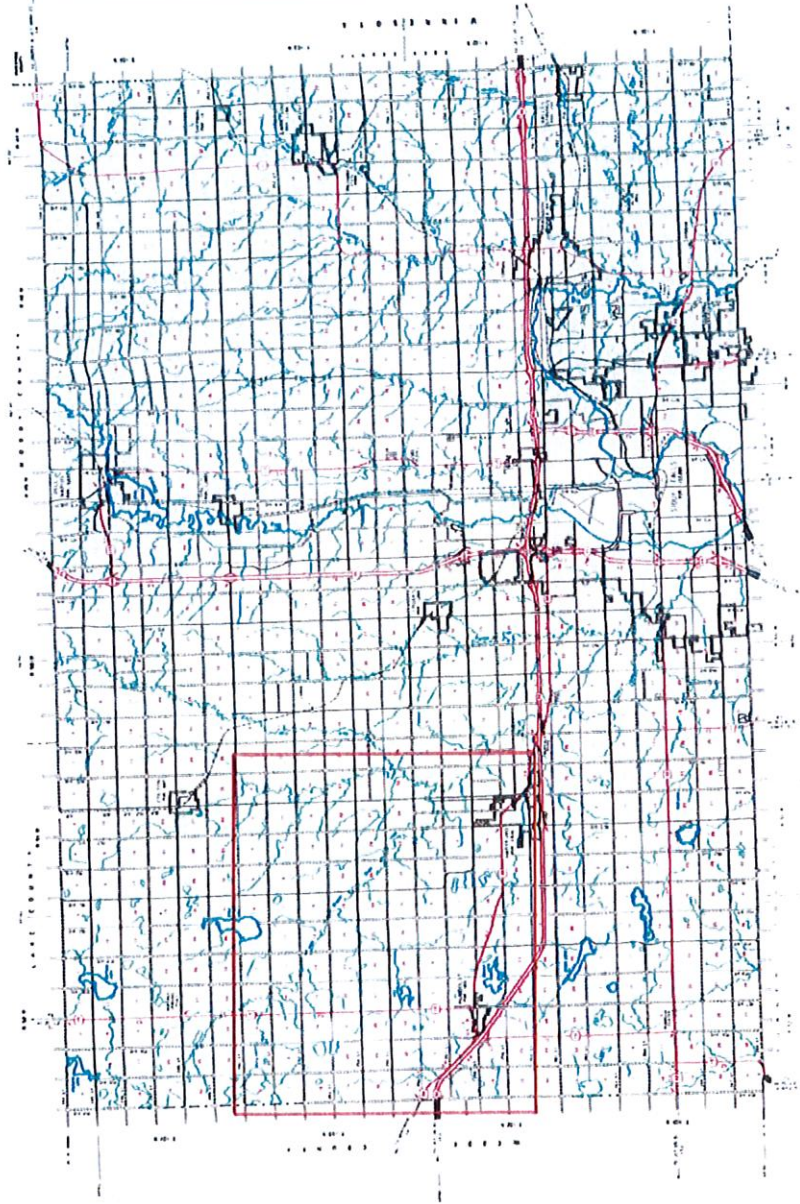

Symbol	Description
[Red double line]	Interstate Highway
[Red single line]	State Highway
[Black double line]	County Road
[Black single line]	Local Road
[Blue line]	Waterway
[Black outline]	City/Town Boundary
[Red circle]	City/Town
[Black circle]	Unincorporated Community
[Black square]	Section Corner
[Black dot]	Quarter Section Corner
[Black cross]	Section Center
[Black line]	Section Line
[Black line]	Township Line
[Black line]	Range Line
[Black line]	County Line
[Black line]	State Line

ATTACHMENT #3



MINNEHAHA COUNTY HISTORICAL SOCIETY  
200 W 6<sup>th</sup> Street, Sioux Falls, SD 57104  
[info@minnehahahistory.org](mailto:info@minnehahahistory.org) 605-951-9200

June 28, 2019

SD Board on Geographic Names  
Dept. of Tribal Relations  
302 East Dakota  
Pierre, SD 57501

To Whom it may concern,

In response to your letter seeking comment on the proposed name for the unnamed tributary of Skunk Creek in Hartford, South Dakota, the Minnehaha County Historical Society would like to respond in support of the proposed name, Turtle Creek.

- The tributary has not appeared with a name on any historic maps the MCHS is aware of.
- The tributary needs the name used for several years now that is already familiar to the community and is used for community and emergency reference.
- The name was suggested by a child of the community.
- Turtles have always been found in and around the creek.

Thank You for your consideration,  
Sandy Dean  
MCHS Secretary  
and  
Hartford Resident  
PO Box 116  
Hartford, SD 57033  
605-528-6290  
[hartfordstuff@peoplepc.com](mailto:hartfordstuff@peoplepc.com)

## Hansen, June

---

**From:** Hansen, June  
**Sent:** Friday, March 1, 2019 10:34 AM  
**To:** publicworks@unitelsd.com  
**Subject:** RE: [EXT] Turtle Creek

Craig: I got your voicemail & your email. Sending the information via email is just fine. The next step in our process is for me to call a Board meeting to bring your request forward. I am not sure when that will be but I will keep you posted. You wouldn't need to do anything for this meeting. This meeting would just be to notify the board publicly of the request and set up the public involvement process. At some point, we would schedule a board meeting in Hartford to take public comment and will probably ask for your help in finding a location and what time you think would be best to meet.

I would reiterate what I mentioned when we talked. The US Board on Geographic Names who ultimately has the authority to approve the name or not has policies regarding having features with the same names in States or nearby. I don't know what they define as "nearby". I was verbally told within the state, but I don't know how strict they are on that. This is the policy:

### Policy VII. Duplicate and Similar Names

Geographic names provide unambiguous labels that identify geographic features. Local duplication of names (i.e., the use of identical names), or even the use of very similar names (i.e., names spelled differently but pronounced the same), often causes confusion and misunderstanding. Name duplication and the use of very similar names, however, are common within a county, State, or nation because naming is a natural process. While name duplication and very similar names in close proximity is undesirable, well-established geographic names should not be changed unless there is evidence of strong public support for the change.

Sec. 1 The BGN will normally disapprove a name proposed for a geographic feature that is already applied to another nearby feature.

Sec. 2 The BGN will normally disapprove a name proposed for a geographic feature when, in the BGN's opinion, the name is so similar to that of a nearby named feature that it will cause confusion.

Sec. 3 The BGN encourages efforts by Tribal, State, and local governments, land management agencies, and local citizens to propose changes or modifications to one or more duplicate or very similar names wherever ambiguity occurs.

### Guidelines

Name duplication occurs when two or more places or features of the same kind, in close proximity to each other, have the same name in local or published usage. Name duplication may not be perceived to occur when places or features of different kinds have the same name, such as a stream named Long Creek and a community named Longcreek or Long Creek. Similarly, names are not considered to be duplicated if the specific parts are the same and the generic parts are different. For example, Long Creek and Long Branch are not duplicate names. Examples of very similar names to be avoided in close proximity would include House Mountain and Haus Mountain or Wilson Creek and Willson Creek.

I can't tell you what the US Board will or won't do when they receive this request. I am just making you aware of the policy. I did a search of the features with Turtle Creek and most appear to be west river over the creeks in Hand & Spink counties. This is the list:

## Feature Query Results

Click the feature name for details and to access map services  
 Click any column name to sort the list ascending ▲ or descending ▼

Feature Name ▲	ID	Class	County	State	Latitude	Longitude	Elev(ft)	Map	BGN Date
<a href="#">East Branch Turtle Creek</a>	1265966	Stream	Meade	SD	444935N	1020210W	2264	Avance SE	- 0
<a href="#">Little Turtle Creek</a>	1253576	Stream	Hand	SD	443640N	0984516W	1371	Miller SE	- 1
<a href="#">Little Turtle Creek</a>	1266125	Stream	Ziebach	SD	444546N	1015906W	2083	Chasing Hawk Draw	- 0
<a href="#">North Branch Turtle Creek</a>	1266187	Stream	Meade	SD	445054N	1020358W	2313	Avance SE	- 0
<a href="#">Township of Turtle Creek</a>	1268794	Civil	Meade	SD	444847N	1020202W	2290	Avance SE	- 2
<a href="#">Turtle Creek</a>	1258649	Stream	Harding	SD	454112N	1031054W	2694	Reva NW	- 1
<a href="#">Turtle Creek</a>	1258650	Stream	Spink	SD	445446N	0982907W	1250	Ashton	- 1
<a href="#">Turtle Creek</a>	1266362	Stream	Ziebach	SD	444541N	1015855W	2067	Chasing Hawk Draw	- 0
<a href="#">Turtle Creek</a>	1267246	Stream	Jackson	SD	433010N	1014849W	2572	Interior SE	- 1
<a href="#">Turtle Creek Dam</a>	1260608	Dam	Harding	SD	454218N	1031114W	2743	Reva NW	- 2
<a href="#">West Branch Turtle Creek</a>	1266497	Stream	Meade	SD	445054N	1020358W	2313	Avance SE	- 0

View & Print All Data as a single PDF document file.

You've provided a great deal of documentation already that we will keep and when we send the final recommendation to the US Board, we will include all of it and anything else we get along the way.

If you have questions, please contact me. I will be in the office on Monday and then I'll be out March 5 & 6. Then I'll be back in the office for the remainder of the week and week after before I travel again.

Thank you for your submission.

June D. Hansen, Chair

South Dakota Board on Geographic Names  
 Representing the SD Department of Transportation

605-773-3540 (Office)  
 605-280-5146 (Cell)  
 605-773-4442 (Fax)

-----Original Message-----

From: publicworks@unitelsd.com <publicworks@unitelsd.com>  
 Sent: Wednesday, February 27, 2019 2:10 PM  
 To: Hansen, June <June.Hansen@state.sd.us>  
 Cc: cityhall@hartfordsd.us  
 Subject: [EXT] Turtle Creek

Good afternoon June, here is the request for the City of Hartford to name the unnamed tributary that runs through Hartford; (Turtle Creek).

Let me know if you need any other information. Thanks and have a great day. Craig

Craig Wagner

Public Works Supt.  
City of Hartford  
(605) 366-6115

## Board on Geographic Names

In 2009 the City of Hartford installed playground equipment on a piece of city owned land. At that time the park had no name. The local day cares where asked to come up with some ideas for a name. So it was decided to call the park "Turtle Creek Park". Along with that the unnamed tributary of the Skunk Creek became "Turtle Creek". Since then we built a junior baseball field which is called "Turtle Creek Field". As of today the locals and even the fire department members call it Turtle Creek. Recently a new development (owned by Sam Assam) has started east of town and Sam named it Turtle Creek Highlands Addition. And of course the streets names are foreign names for turtles. Please consider the naming of the unnamed tributary to "Turtle Creek" as the locals, fire department members and new developers all call it. Thanks Craig

Craig Wagner  
Public Works Supt.  
City of Hartford

*South Dakota*  
Board on Geographic Names

Propose New Name  
or Name Change of  
Geographic Feature

*The South Dakota Board on Geographic Names (SDBGN) is a state commission created in 2006 by SDCL Chapter 1-10C. The SDBGN has adopted a Public Involvement Process which seeks public comment on the existing historic name and offering recommendations and justification for the new name as well as names for unnamed geographic features. The SDBGN follows the United States Board on Geographic Names' principles, policies, and procedures. For further information visit <http://geonames.usgs.gov/domestic/policies.htm>. Any proposed name changes for municipalities, counties or other political subdivisions of the State of South Dakota should be sent directly to the U.S. Board on Geographic Names for consideration.*

Proposed Name: Turtle Creek

Action Requested:

- Name an unnamed feature
- Change name of existing feature

Reason for requesting name change or proposing a name for unnamed feature:

The City of Hartford would like to name the unnamed tributary of Skunk Creek to "Turtle Creek" to correspond with our park, ball field and our new addition east of town. The locals around Hartford believe Turtle Creek is the name of the tributary at this time. When I heard the fire department members call it Turtle Creek during our winter rescue, I reminded them that it is an unnamed tributary of the Skunk Creek. I mentioned that if we called in a call at Skunk Creek it would not show on any maps.

Type of Geographic Feature: Unnamed tributay of Skunk Creek

Location of Feature (County/Geographic Coordinates):

Minnehaha County starting at Beaver Lake (43.634, -97.035) and connecting at Skunk Creek at (43.617, -96.881).

Descriptive Information of the geographic feature:

The unnamed tributary starts at Beaver Lake by Humboldt South Dakota and runs east to Hartford South Dakota, through town and then east to the Skunk Creek.



**Meaning or Significance of the proposed name:**

To correspond to our park, ball field and Turtle Creek Highlands Addition.

**Intended to Commemorate/Honor an Individual** Y  N   
**If yes, who?**

**Are you representing an organization/public entity or acting as an individual? If representing an organization or public entity, please identify the organization and your role.**

I'm the Public Works Supt. for the City of Hartford.

**Please provide any letters of support for the new name and list any public entities or organizations that have indicated support for the new name below:**

Please see the attachments.

**Submitted by:**

**Name:** Craig Wagner  
**Title (if representing organization or public entity):** Public Works Supt.  
**Organization or Public Entity (if applicable):** City of Hartford  
**Mailing Address:** 125 N Main Ave. Hartford, South Dakota 57033  
**Telephone:** (605) 366-6115  
**Email Address:** publicworks@unitelsd.com

*If the recommended name is adopted by the SDBGN, additional information may be needed to support the recommendation to the U.S. Board on Geographic Names.*

**Submit form to:**

SD Board on Geographic Names  
Dept. of Tribal Relations  
302 East Dakota  
Pierre, SD 57501

Email: [david.reiss@state.sd.us](mailto:david.reiss@state.sd.us)  
FAX: 605-773-6592

**Website:** <http://www.sdbgn.sd.gov/>

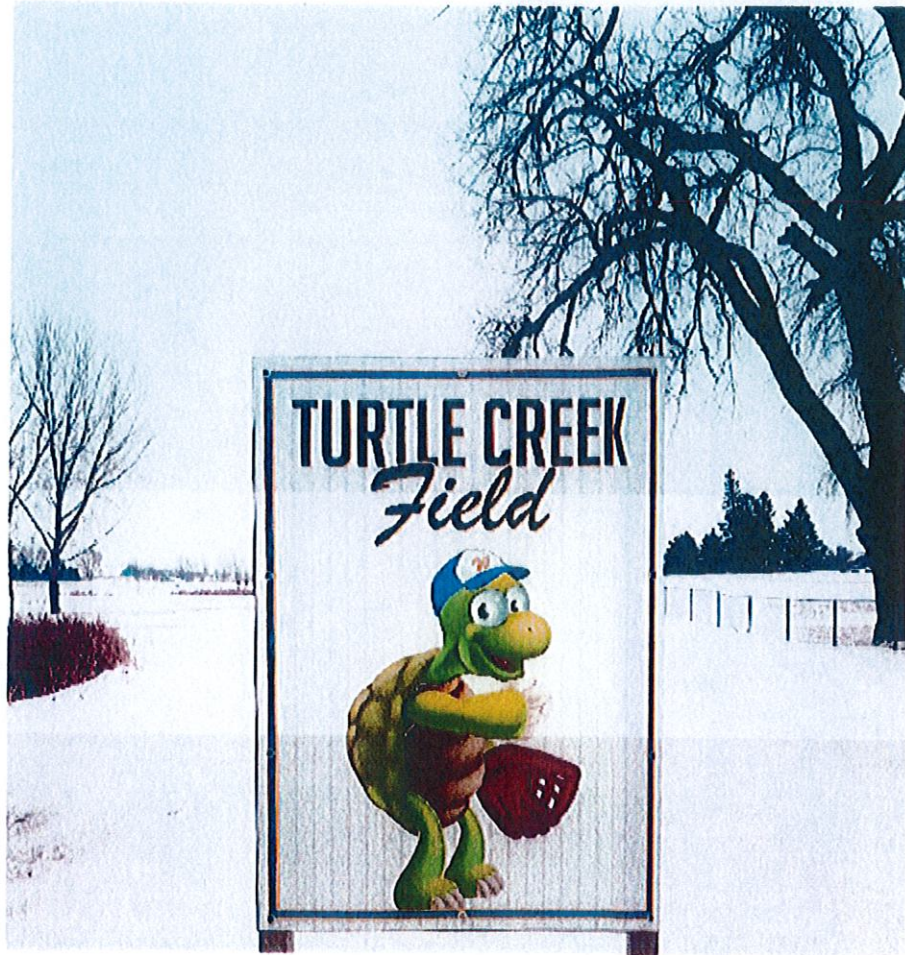

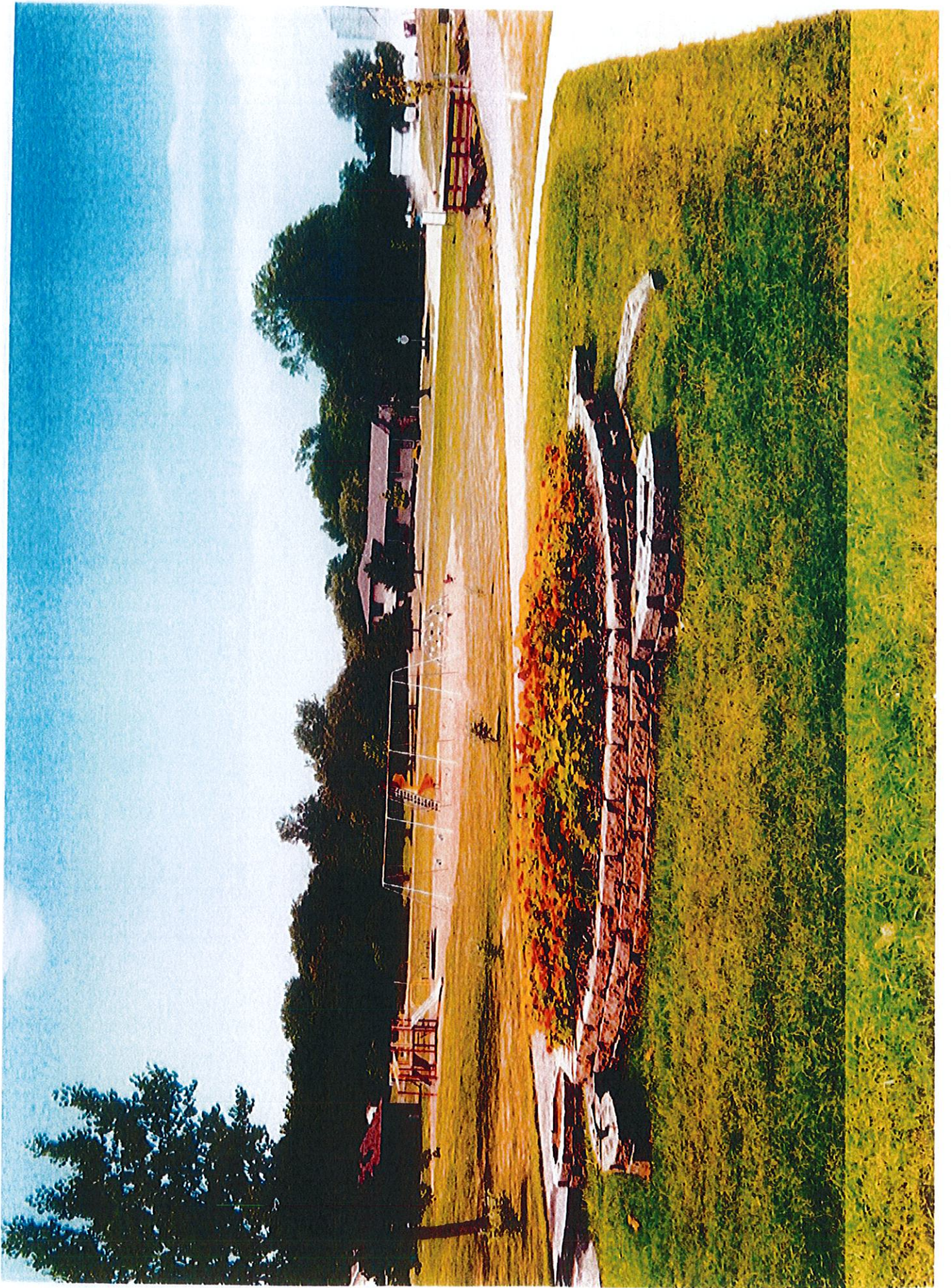

---

# Hartford Area Fire & Rescue

12/17/2019

705 W South St  
Hartford, SD 57053

To whom it may concern:

This letter will serve as acknowledgement and support of naming the current unnamed water body, flowing through the City of Hartford, South Dakota, Turtle Creek. The residents of the area currently refer to this water body as Turtle Creek. As emergency response to many situations near this body of water have occurred, the people calling 911 for assistance reference their location as near "Turtle Creek". Thereby I feel it would be appropriate to officially name this body of water Turtle Creek to synchronize what emergency callers are using as a location reference with official maps used by the 911 call center.

Sincerely,



Bryon Shumaker

Chief

Hartford Area Fire & Rescue

605-231-0856



## CITY OF HARTFORD

125 N. Main • Hartford, SD 57033  
Telephone: (605) 528-6187 • Fax: (605) 528-3320  
[www.hartfordsd.us](http://www.hartfordsd.us)

---

February 15, 2019

On behalf of the City of Hartford, I would like to request naming the "unnamed tributary" identified on the attached map as "Turtle Creek". This unnamed tributary runs right through the City of Hartford and has been called Turtle Creek for many years now by the local citizens. When the city established a park in 2009 along this tributary, we called the park "Turtle Creek Park". Then in 2011, the city established a ball field along this tributary and it is called "Turtle Creek Field". The name is so popular that we now have a new development called "Turtle Creek Highlands" that is being established along this tributary as well. The development uses the Turtle Creek name for the development and for its main street – it also incorporates the names of various turtles for the streets within the development. The local fire department and emergency crews also refer to this tributary as Turtle Creek and use it as reference for their emergency calls.

Hartford is the only city along this unnamed tributary and we strongly support the naming of the unnamed tributary as "Turtle Creek".

Sincerely,

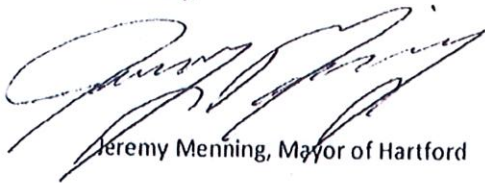

Jeremy Menning, Mayor of Hartford



## TURTLE CREEK HIGHLANDS, INC.

530 S. Phillips Avenue  
Sioux Falls, SD 57104

\*Also Admitted In Minnesota

Phone: 605-334-8040

Fax: 605-334-9856

February 22, 2019

Teresa Sidel  
Hartford City Administrator  
125 North Main Avenue  
Hartford, South Dakota 57033

*via: email – cityhall@hartfordsd.us  
and USPS*

RE: RENAME UNNAMED TRIBUTARY TO TURTLE CREEK

Dear Ms. Sidel:

I am writing this letter to state my full support for renaming that certain unnamed tributary running through property that is owned by Turtle Creek Highlands, Inc. to "Turtle Creek". I think this is a very appropriate and fitting name given that the City of Hartford has already been calling this same unnamed tributary running through one of its existing parks "TURTLE CREEK". I would be available to discuss if you have any further questions or concerns regarding this manner.

Very Truly Yours,

TURTLE CREEK HIGHLANDS, INC.



Samuel R. Assam  
President

*The  
Family  
Farm*

# 2013 Hartford Tree Planting

## Proposal / Turtle Creek Drainage

**South Dakota Nursery Stock Dealer # N-13330, Exp  
12/31/2013**

Date: April 29, 2019  
INVOICE # [100]

All trees subject to availability, any substitutions will be of equal or greater size and value.

To City of Hartford  
Hartford, SD 57033

All trees will be installed and come with 1yr replacement guarantee.

Salesperson	Job	Shipping Method	Shipping Terms	Delivery Date	Payment Terms	Due Date
Mike Smith				After 4/23/2013		

Qty	Item #	Description	Unit Price	Discount	Line Total
5		1 1/4" Heritage Oak	150.00		750.00
3		1 1/4" State Street Maple	140.00		420.00
3		1 1/4" Marmo Maple	150.00		450.00
5		1 1/4" Sienna Glenn Maple	165.00		825.00
2		1 1/4" Autumn Blaze Maple	160.00		320.00
5		1 1/4" Emerald Lustre Maple	140.00		560.00
4		1 1/4" Accolade Elm	140.00		560.00
4		1 1/4" Triumph Elm	120.00		480.00
4		1 1/4" Serbian Spruce	150.00		600.00
4		1 1/4" Auslrian Pine	150.00		600.00
6		1 1/4" Black Alder	125.00		750.00
Total					6315.00
Total Discount					Volume Discount
					315.00
					Subtotal
					6000.00
					Sales Tax
					N/A
					Total
					6000.00

**Thank you for your business!**

**The Family Farm**

**Mike Smith**

**25358 459<sup>th</sup> Ave.**

**Humboldt, SD 57035**

**605 359-7757**