

Department of Transportation  
Division of Secretariat  
Office of Air, Rail & Transit  
700 East Broadway Avenue  
Pierre, South Dakota 57501-2586  
OFFICE: 605/773-3574  
FAX: 605/773-2804

TO: South Dakota Aeronautics Commission  
FROM: Jack Dokken, Office of Aeronautics  
DATE: January 16, 2018  
SUBJECT: Aeronautical Hazard Application

**Permit #'s 2017-13607-13614 Sioux Falls, SD**  
FAA Aeronautical Study 2017-AGL-13607- 13614-OE

The City of Sioux Falls is rebuilding an existing electric transmission line with new laminated wood structures (Structure #'s T1-T8). It is being rebuilt generally in the existing alignment with the closest structure being approximately 1,650 feet southeast of the Sioux Falls airport.

The FAA has determined:

- ◆ This proposal does not exceed FAA obstruction standards and would not be a hazard to air navigation.
- ◆ Aeronautical studies 13608 thru 13612 must be marked/lighted as per FAA requirements.

The department is recommending Commission approval.

SD EForm - 0941 V2

APPLICATION FOR LOCATION OF AERONAUTICAL HAZARD

State Permit #:

South Dakota Aeronautics Commission
Becker-Hansen Building, 700 E Broadway Avenue
Pierre, South Dakota 57501-9989
Air, Rail and Transit (605)773-3574

2017-AGL-12311-OE to
2017-AGL-12318-OE

FAA Airspace #:

A. APPLICANT

Proponent:

Proponent's Representative:

Company: City of Sioux Falls
Address: 2000 North Minnesota Ave
Sioux Falls SD 57104
Phone: (605) 373-6979
Attention: Jerry Jongling

Company: DGR Engineering
Address: 1302 South Union St
Rock Rapids IA 51246
Phone: (712) 472-2531
Attention: Troy Metzger

B. TYPE OF STRUCTURE

Type: [X] New Construction
[ ] Alteration
[ ] Existing

Work Schedule Dates:
Begin Date: 04/01/2018
End Date: 12/01/2018

Nature and Complete Description of Structure

(Type of material, obstruction lighting and painting and any special marking):

New laminated wood structures (Str #'s T1-T8) for an electric transmission line that is being rebuilt generally in the existing alignment. No special lighting, painting, or markings are included.

C. LOCATION INFORMATION

Latitude: See attached Longitude: See attached Nearest City: Sioux Falls
Dist & Direction to City: Inside City limits.

Nearest Public Use Airport:

Location Description:

Airport/City: Sioux Falls Regional Airport/
Distance & Directions to Airport: Sioux Falls; Airport is NW of
Str's-see attached for distance.

The structures listed in the attached will be located in
Section 9 of Township 101N and Range 49W in the City of
Sioux Falls - see attached map.

Height of Structure:

- a. Site Elev. ft. (MSL)... See attached
b. Structure Height: ft. (AGL).. See attached
c. Overall Height: ft. (MSL).... See attached

Nearest State Hwy & Distance to Hwy Centerline:

Minnesota Ave (State Hwy 115) is approximately 550' from the closest structure.

THE UNDERSIGNED HEREBY AGREES TO SUCH FURTHER REQUIREMENTS AS THE STATE AERONAUTICS COMMISSION MAY PRESCRIBE
RELATING TO MARKING, LIGHTING AND SAFETY TO THE FLYING PUBLIC AS MAY FROM TIME TO TIME BE ADOPTED BY THE COMMISSION FOR
TOWERS 499' AND TALLER.

CERTIFICATION: I hereby certify that all of the above statements made by me are true, complete and correct to the best of my knowledge and belief.

Date: 7-17-17 Name and Title: Jerry Jongling Electric Superintendent Signature: [Handwritten Signature]

STRUCTURE DATA FOR SD AERONAUTIC COMMISSION -  
CITY OF SIOUX FALLS - 115 kV SOUTH TRANSMISSION LINE REBUILD PROJECT

| Structure Number | Structure Name    | Longitude (DMS) | Latitude (DMS) | Distance from runway edge (ft) | Closest Runway | Elevation MSL (ft) | Structure Height AGL (ft) | Overall Height MSL (ft) |
|------------------|-------------------|-----------------|----------------|--------------------------------|----------------|--------------------|---------------------------|-------------------------|
| T1               | Transmission Pole | 96d43'38.322"W  | 43d34'14.943"N | 1,656                          | 33             | 1420.10            | 65.5                      | 1486.35                 |
| T2               | Transmission Pole | 96d43'40.548"W  | 43d34'12.52"N  | 1,646                          | 33             | 1421.10            | 65.5                      | 1487.35                 |
| T3               | Transmission Pole | 96d43'41.974"W  | 43d34'10.968"N | 1,676                          | 33             | 1423.00            | 65.5                      | 1489.25                 |
| T4               | Transmission Pole | 96d43'42.042"W  | 43d34'8.417"N  | 1,866                          | 33             | 1422.40            | 61.0                      | 1484.15                 |
| T5               | Transmission Pole | 96d43'42.109"W  | 43d34'5.916"N  | 2,066                          | 33             | 1420.10            | 61.0                      | 1481.85                 |
| T6               | Transmission Pole | 96d43'41.683"W  | 43d34'3.426"N  | 2,294                          | 33             | 1422.70            | 61.0                      | 1484.45                 |
| T7               | Transmission Pole | 96d43'41.264"W  | 43d34'0.973"N  | 2,524                          | 33             | 1423.50            | 61.0                      | 1485.25                 |
| T8               | Transmission Pole | 96d43'40.816"W  | 43d33'58.352"N | 2,775                          | 33             | 1426.10            | 61.0                      | 1487.85                 |



Plot Date: 7/17/2017 8:13:19 AM

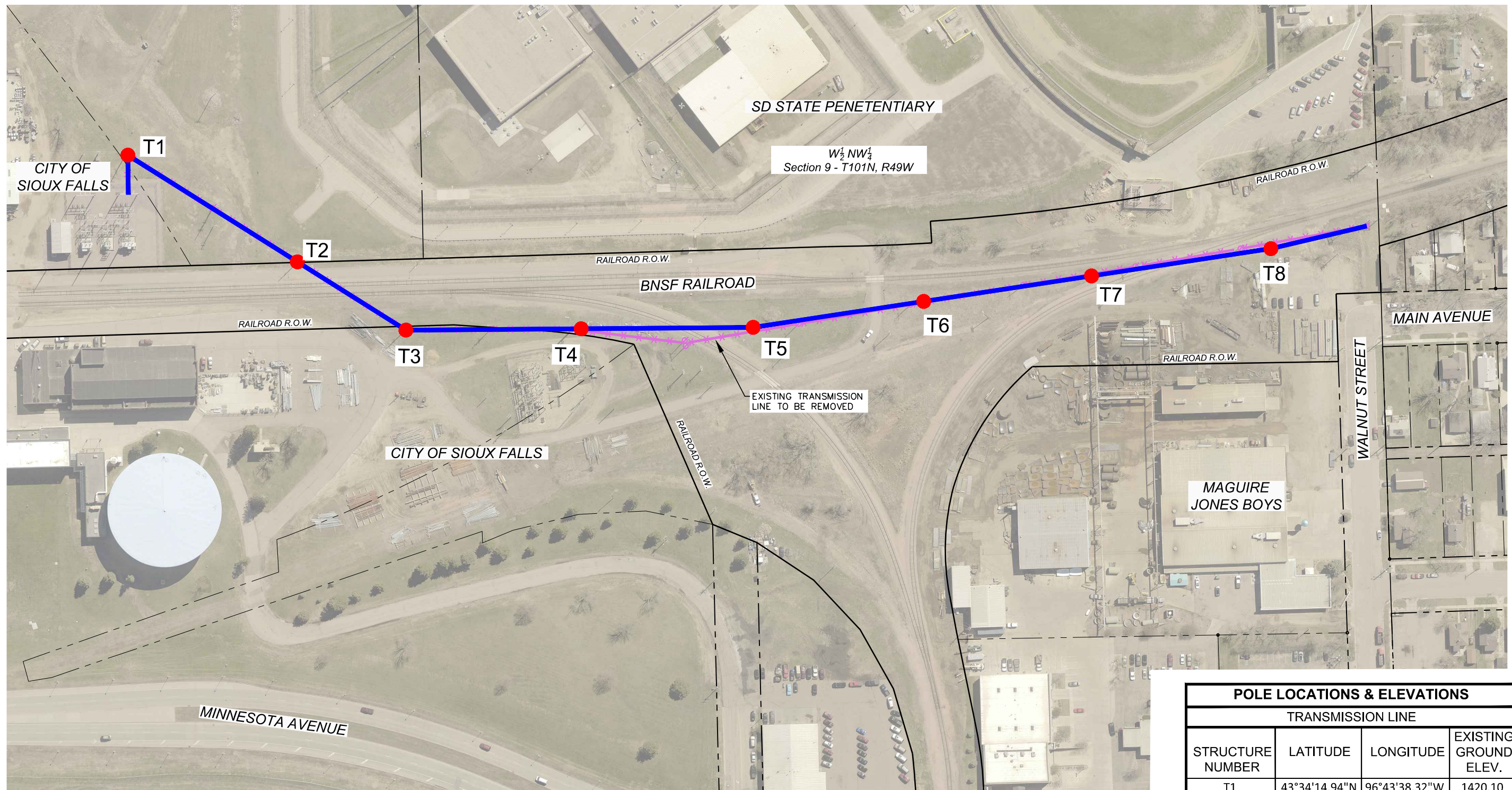

| POLE LOCATIONS & ELEVATIONS |               |               |                       |
|-----------------------------|---------------|---------------|-----------------------|
| TRANSMISSION LINE           |               |               |                       |
| STRUCTURE NUMBER            | LATITUDE      | LONGITUDE     | EXISTING GROUND ELEV. |
| T1                          | 43°34'14.94"N | 96°43'38.32"W | 1420.10               |
| T2                          | 43°34'12.52"N | 96°43'40.55"W | 1421.10               |
| T3                          | 43°34'10.97"N | 96°43'41.97"W | 1423.00               |
| T4                          | 43°34'08.42"N | 96°43'42.04"W | 1422.40               |
| T5                          | 43°34'05.92"N | 96°43'42.11"W | 1420.10               |
| T6                          | 43°34'03.43"N | 96°43'41.68"W | 1422.70               |
| T7                          | 43°34'00.97"N | 96°43'41.26"W | 1423.50               |
| T8                          | 43°33'58.35"N | 96°43'40.82"W | 1426.10               |

NOTE: HORIZONTAL COORDINATE SYSTEM - WGS84  
VERTICAL DATUM - NAVD88

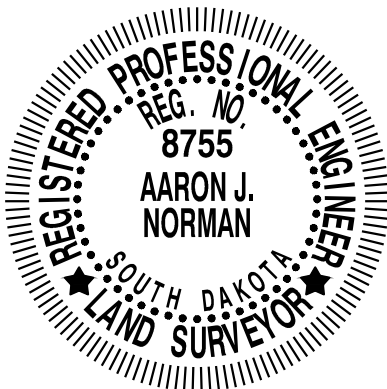

I HEREBY CERTIFY THAT THIS SURVEY INFORMATION WAS PREPARED BY ME OR UNDER MY DIRECT PERSONAL SUPERVISION AND THAT I AM A DULY REGISTERED PROFESSIONAL ENGINEER AND LAND SURVEYOR UNDER THE LAWS OF THE STATE OF SOUTH DAKOTA.

**AA** 7.17.17  
AARON J. NORMAN, P.E./L.S.  
REG. NO. 8755

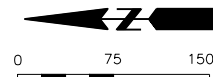

**PROPOSED ELECTRIC LEGEND**

- PROPOSED OVERHEAD TRANSMISSION
- - - EXISTING TRANSMISSION LINE TO BE REMOVED

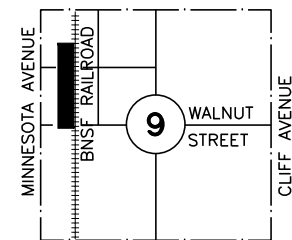

**KEY MAP**  
SECTION 9-101-49

115 kV SOUTH TRANSMISSION LINE  
CIRCUIT IMPROVEMENTS  
SIOUX FALLS, SD

Site Layout

REVISIONS

Project Manager: AJN  
Designer: AJN  
Project Number: 414026  
Phone: (605) 339-4157

**CITY OF SIOUX FALLS**  
**PUBLIC WORKS**  
Providing a Better Quality of Life for You!



Sheet  
1