

Department of Transportation  
Division of Secretariat  
Office of Air, Rail & Transit  
700 East Broadway Avenue  
Pierre, South Dakota 57501-2586  
OFFICE: 605/773-3574  
FAX: 605/773-2804

TO: South Dakota Aeronautics Commission  
FROM: Jack Dokken, Office of Aeronautics  
DATE: October 5, 2020  
SUBJECT: Financial Assistance Agreements

---

Airport sponsors are requesting funding from the State Aeronautics Fund for the AIP projects below.

**Belle Fourche 3-46-0072-014-2020**

Update the airport master plan, airport layout plan, perform aeronautical survey and exhibit A property map.

Federal Share	\$370,261.70
State Share	\$
Local Share	\$
Total	\$370,261.70

**Watertown 3-46-0058-037-2020**

Construct new terminal building; air carrier ramp construction.

Federal Share	\$ 9,000,000.00
State Share	\$ 269,233.13
Local Share	\$ 3,521,509.25
Total	\$ 12,790,742.38

Belle Fourche Municipal Airport  
Airport Master Plan  
Project Justification  
June 2020

The City of Belle Fourche is completing an Airport Master Plan with Aeronautical Survey and Exhibit "A" Property Map to update the Airport Layout Plan (ALP) previously approved in 2001. The existing ALP is outdated and does not comply with current Federal Aviation Administration (FAA) design standards. The project will provide aeronautical survey information for existing facilities to supply information to the FAA's Airport Data and Information Portal (ADIP) and will also be completed in compliance with FAA SOP 2.0 ALP Review Checklist and 3.0 Exhibit A Review Checklist. There is also a need to provide an overall examination of the airfield with current data and updated usage information and to look at areas for hangar development.

**PART IV – PROGRAM NARRATIVE**  
(Suggested Format)

<b>PROJECT:</b> AIP #3-46-0058-037-2020
<b>AIRPORT:</b> Watertown Regional Airport
<b>1. Objective:</b> Terminal Building Construction  Partial Air Carrier Ramp Construction
<b>2. Benefits Anticipated:</b> In conjunction with the new terminal building being constructed at ATY, this project shall construct a portion of the air carrier ramp. A partial construction of the ramp this season may allow use of the new facilities at a sooner than anticipated dates.
<b>3. Approach:</b> (See approved Scope of Work in Final Application)  Award Construction Contracts Review Construction Management Plan Issue Notice to Proceed/Pre-construction Meeting Construct Partial Air Carrier Ramp Provide Construction As-builts Provide Project Closeout Documents
<b>4. Geographic Location:</b>  Watertown Regional Airport, Coddington County, South Dakota
<b>5. If Applicable, Provide Additional Information:</b>
<b>6. Sponsor's Representative:</b> (include address & telephone number)  Sarah Caron, Mayor 605-882-6200 PO Box 910 Watertown, SD 57201-0910

## **Project Narrative and Justification**

### **Narrative**

This project is anticipated to be one phase of the New Airport Terminal Project at Watertown Regional Airport. The project is proposed to construct a new terminal building, terminal apron, associated taxiways, parking lots, and access roads. This project will include the following:

- Construction of a New Terminal Building, which includes:
  - Civil Landside Construction (broken out based on the Schedule of Values provided by the low bidder)
  - Concrete transitional areas in front of the terminal building
  - Watertown Municipal Utilities (WMU) costs for Gas and Fiber Optic
  - FAA Reimbursable Agreement
- Terminal Bidding and Construction Administration/Engineering
- Civil Airside Construction – Partial Air Carrier Ramp Construction (bid separately)
- A portion of Civil Bidding and Construction Engineering/Administration

Due to excellent bids for the Terminal Building, additional funding was available for a portion of the Air Carrier Ramp to be bid shortly after the bidding of the Terminal Building. Therefore, there are two construction contracts in this portion of the project.

The City of Watertown applied for a grant earlier in this Fiscal Year to use their entitlements for the design of the entire project. An ARFF Cart was also included in that application. This grant, AIP Grant Number 036-2020, is anticipated to be a multi-year project.

The next phase of the project will be to complete the remaining Civil Site Construction (Apron, Taxiways, Parking, Access Road, Passenger Boarding Bridge, etc.). It is anticipated that a final phase will be to demolish the existing terminal building.

### **Justification**

The current terminal facility is located between the General Aviation (GA) users on the airfield and does not conform to guidelines requiring ample separation of GA and commercial service. The existing building elevation is below the apron, allowing water to drain directly over the hold room gate door threshold and prevents a passenger boarding bridge from being constructed without a significant fixed walkway connected to the building. The location of the Ticketing, Checkpoint Queue, and Baggage Claim all converge creating a small area where enplaning and deplaning passengers converge. Due to the increased number of enplanements in recent years, the current terminal building is not meeting the current demands for passengers and needs to be replaced. The current location limits potential growth and is sandwiched between the GA users on the airfield, creating security concerns for the airport. Therefore a new terminal is proposed in a new location, which requires a new terminal apron, associated taxiways, parking lots, and access road improvements. See the Concept Budget Report (CBR) dated July, 2019 for further justification.

**ROOM LEGEND**

- CHECKPOINT
- PASSENGER
- STAFF

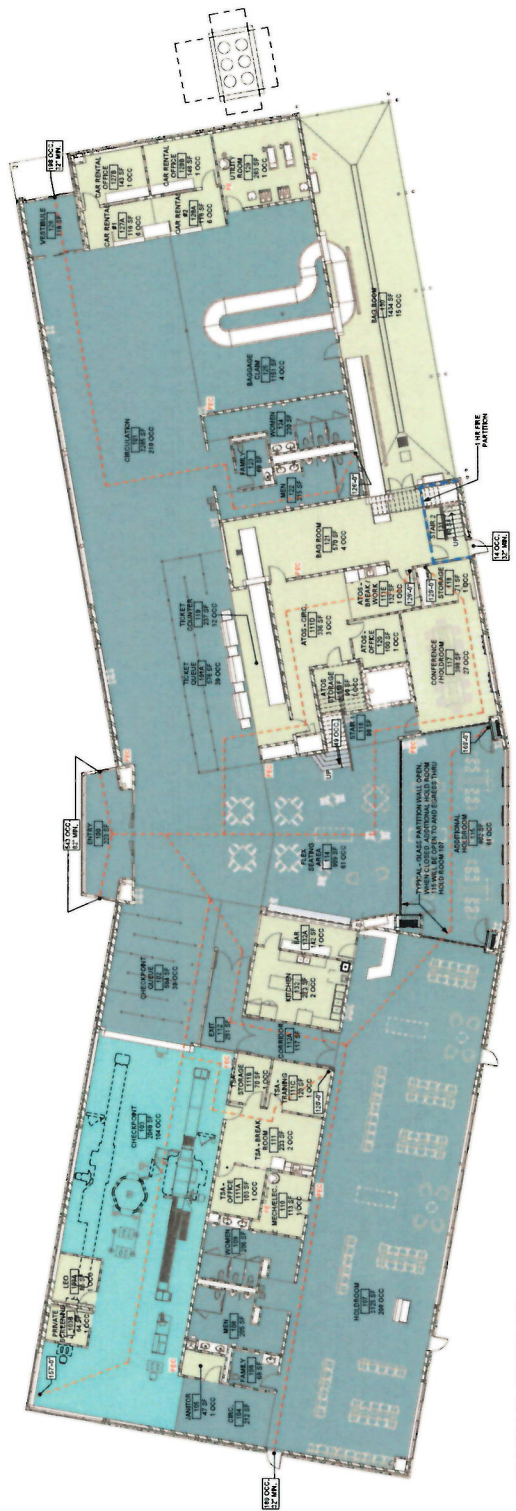

① FLOOR PLAN - FIRST FLOOR  
11/10/07

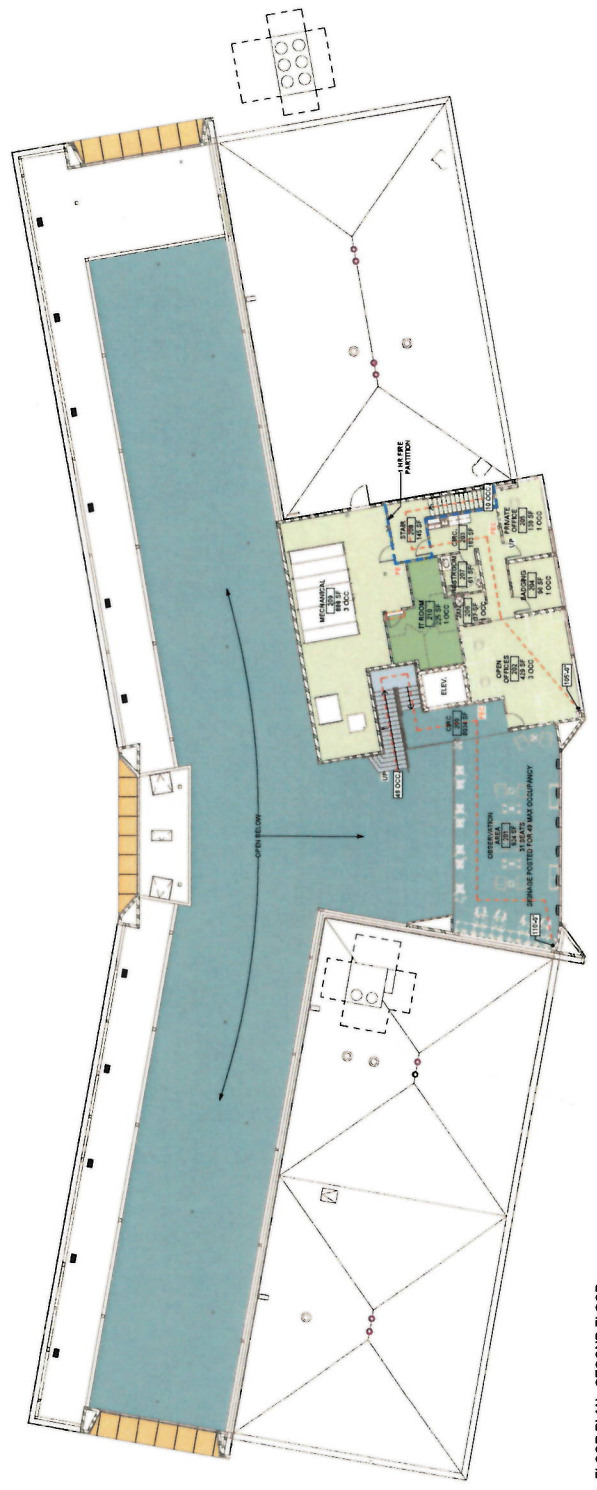

② FLOOR PLAN - SECOND FLOOR  
11/10/07

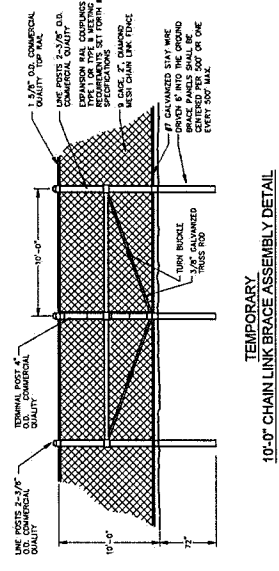
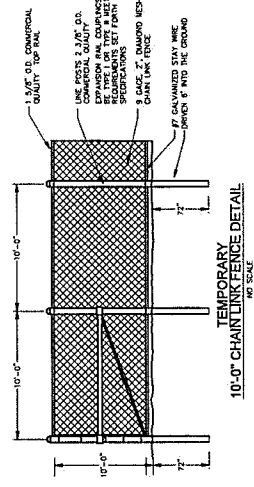
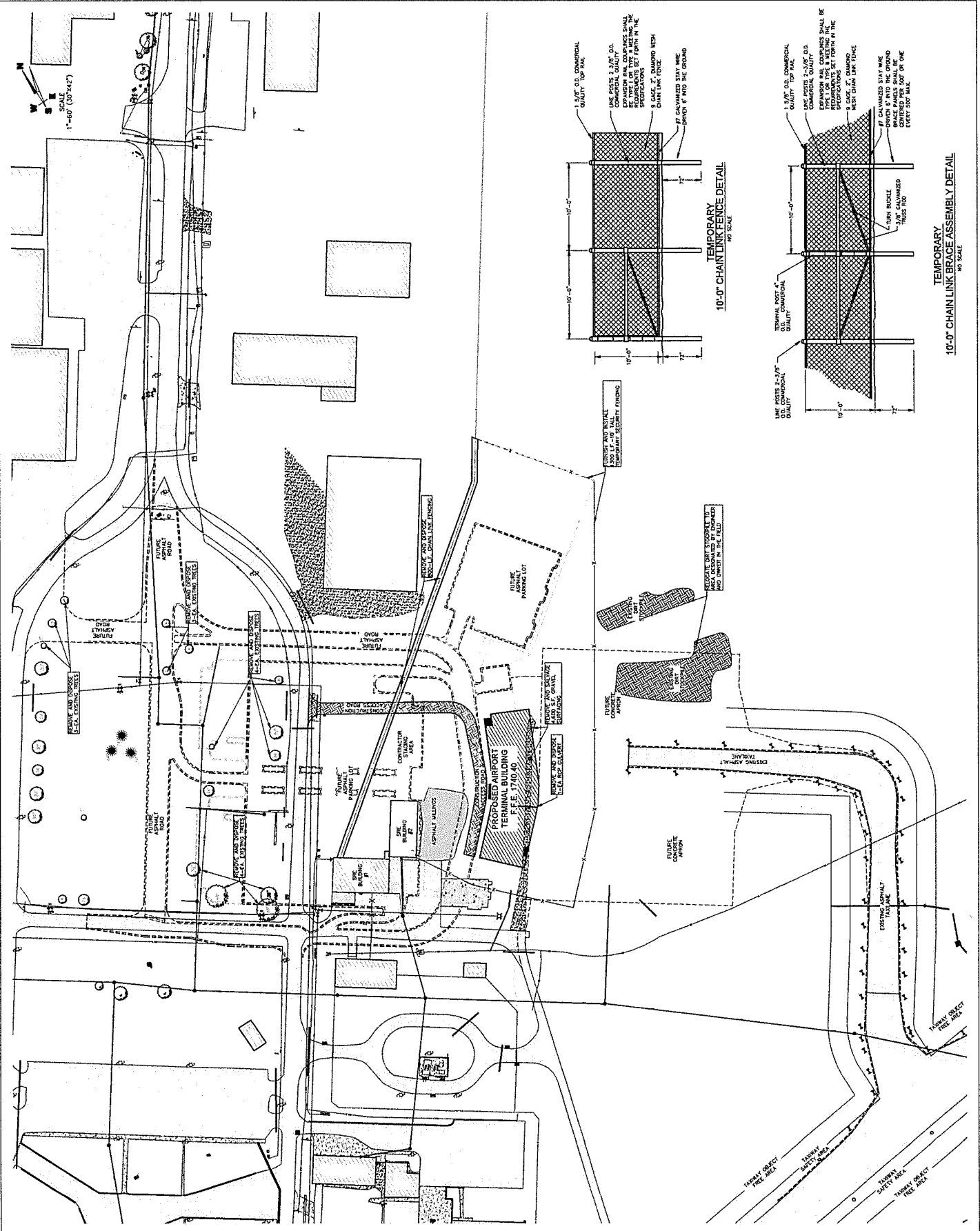

# Mead & Hunt

PROJECT LAYOUT PLAN  
 2 OF 16  
 PARTIAL AIR CARRIER RAMP  
 WATERTOWN REGIONAL AIRPORT  
 WATERTOWN, SOUTH DAKOTA

Drawn By: TAP  
 Date: 01/20  
 Proj. No.: A-195  
 Draw. No.: 1144337  
 Date: 01/20

**Helm & Associates**  
 CIVIL ENGINEERS & LAND SURVEYORS  
 221 Brown County  
 Hillway 15  
 P.O. Box 111  
 Aberdeen, S.D. 57401  
 Phone: 605.225.1121  
 Fax: 605.225.1189  
 Email: helm@helandassociates.com

Registered Professional Engineer  
 MICHAEL J. HELM  
 License No. 11523  
 State of South Dakota  
 8-31-2020

By	App.	Date

